



Periodic inspection checklist – EN

Molift Mover 180, 205 and 300

molift[®]
by Etac

PI08201 - 2025-03-12 - Rev. 1.0

In accordance with ISO 10535

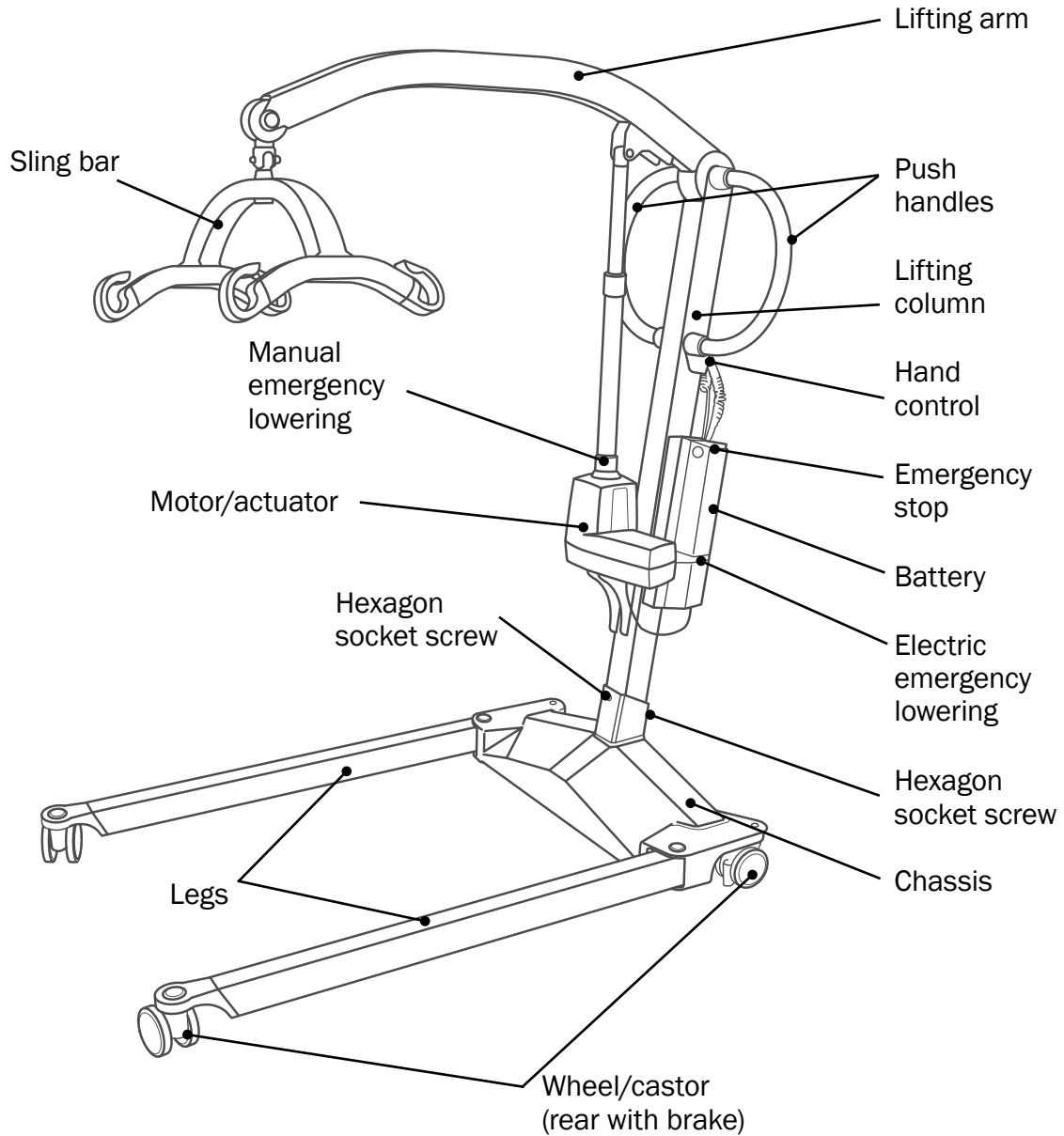

Product label, Mover 180

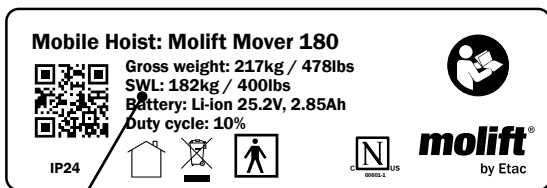

SWL value

Id-label, Mover 180



Serial no.

Article no.

Production date



www.etac.com



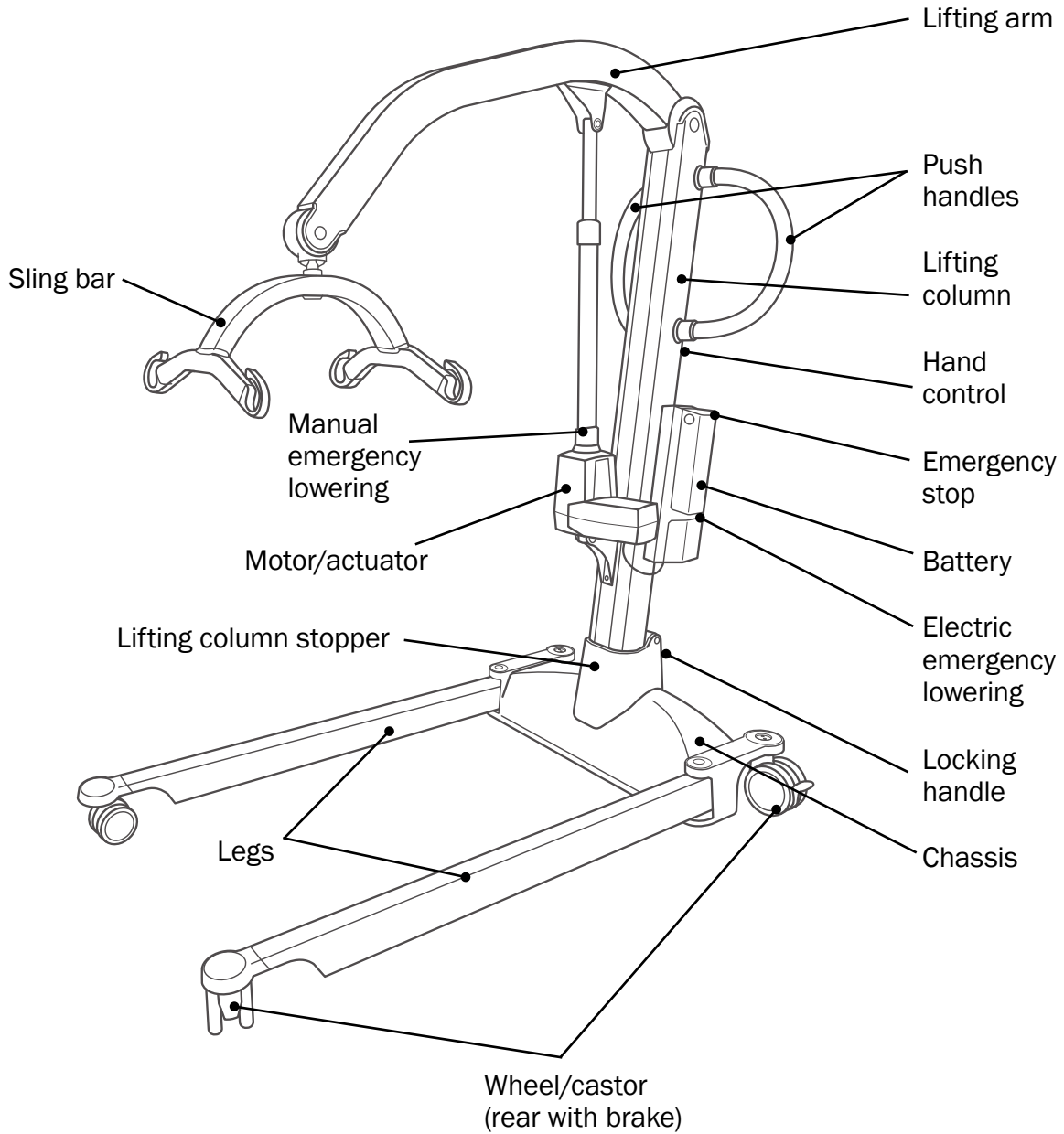

Product label, Mover 205

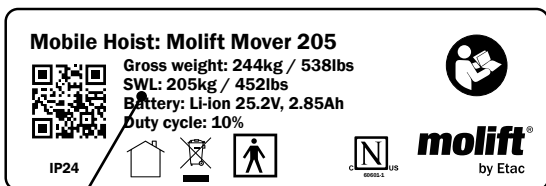

SWL value

Id-label, Mover 205



Serial no.

Article no.

Production date

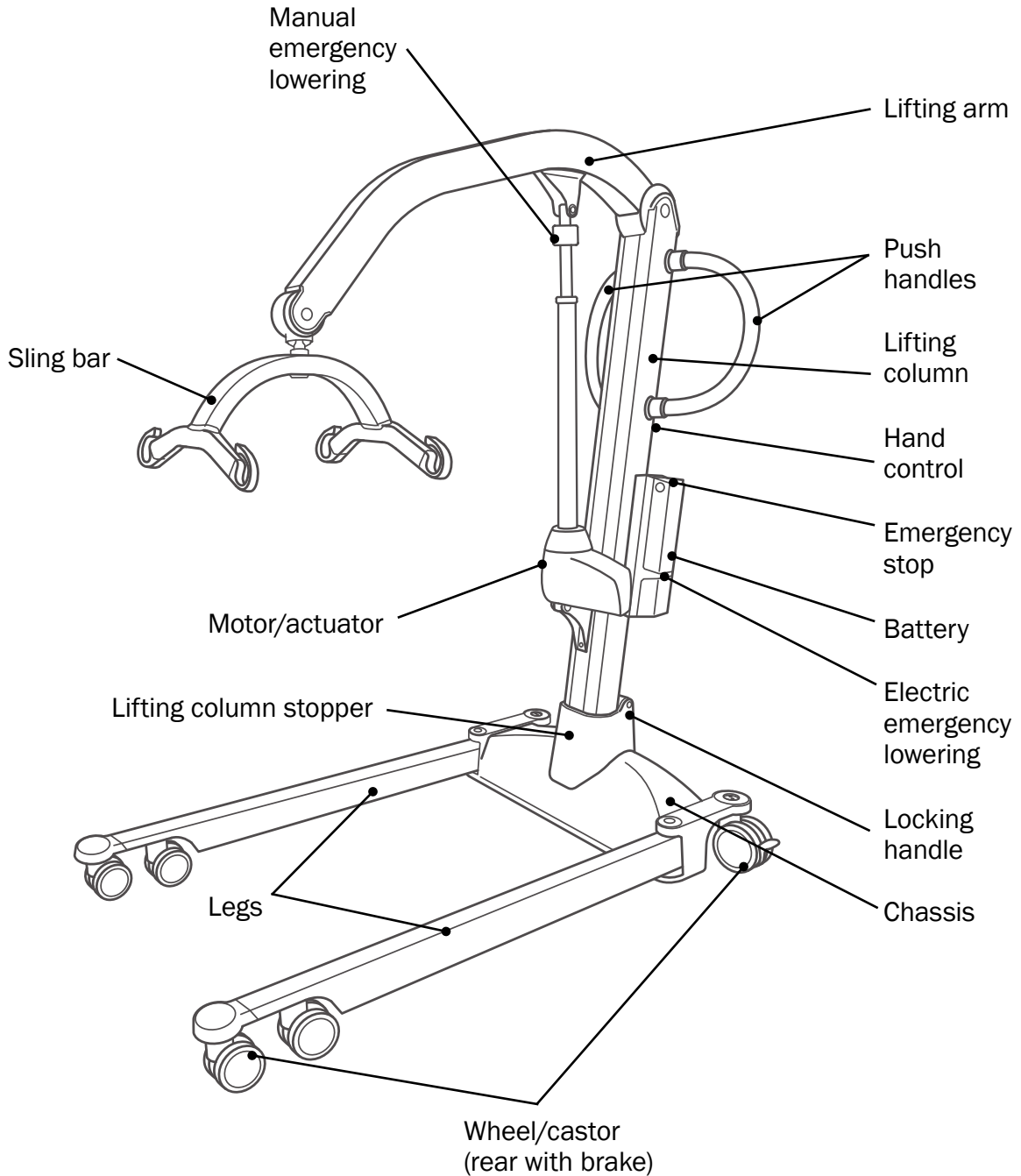

Product label, Mover 300

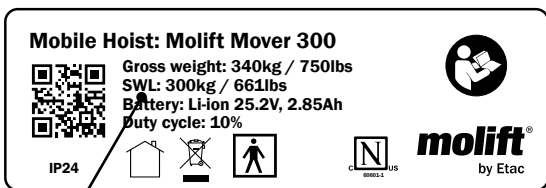

SWL value

Id-label, Mover 300



Serial no.

Article no.

Production date

A copy of this document is available for download at www.etac.com.

Scan QR code on product label for accessing product home page. The user manual can be found in the document section.

Article no. (see ID label):

.....

Serial no. (see ID label):

.....

Production Year:

.....

Owner:

.....

Sling shall be inspected separately and is not included in this inspection.

Specify model:

- Mover 180
- Mover 205
- Mover 300

Situation of use

- Home
- Hospital
- Nursing home
- Other

 The periodic inspection is to be performed by a person who is suitable, properly qualified and well acquainted with the design, use and care of the hoist

 The hoist's software Molift Service Tool provides option to enter date of PI and name of inspector along with additional information. Molift recommends adding all observations/remarks concerning the hoist in the Molift Service Tool for complete history log of the hoist

Service light indicator

Note colour of service light indicator:

Status	Service light	Mode
	(No light)	Service/Periodic inspection not needed
	Yellow	Order service
	Yellow (flash and sound when operated)	Perform service
	Yellow (slowly turns on and off)	Perform Periodic Inspection

Visual examination

 Visual examination of load bearing structure to make sure there is no damage, cracks, frays or deformation. All checkpoints must be checked to approve hoist for further use

OK Not OK

	Lifting column
	Lifting arm
	Legs
	Product label
	Plastic covers
	Hand control
	Actuator
	Wheels/castors
	Brakes on wheels/castors
	Charger
	Cables
	Battery
	Other electronics
	Sling bar
	Leg adjustment mechanism
	No corrosion
	Weldings
	Instruction for use/user manual is present/available

Functional examination



Test function and inspect for wear and damage.
All checkpoints must be checked to approve hoist for further use

OK	Not OK
	Wheels/castors
	Rear wheel/castor brakes
	With legs in inner position (parallel): Check that the distance between legs can not decrease when pushed together by hand
	For Mover 180 only: Lifting column is completely fixed with hexagon locking screws tightly secured
	For Mover 205 and 300 only: Lifting column is completely fixed when locking handle is engaged
	Emergency stop button is fully operational and interrupts power when engaged. Reset switch
	Electrical emergency lowering
	Manual emergency lowering
	Hand control (buttons, strain relief on hand control cable, hook, and battery indicator)
	Sling bar coupling (swivel joint moves freely and without noise)
	Sling bar quick release
	If all points so far are "OK", hoist shall be tested with SWL
	Perform one lifting cycle with weight equal to SWL (see product label for value kg/lbs). Actuator must not slip when loaded (causing lifting arm to lower)
	Leg adjustment mechanism, outwards and inwards with SWL
	Perform new visual control; Damage, play and deformations as described above. Any damaged parts must be repaired or replaced and test is repeated once more until the hoist performs correctly

OK	Not OK
	Charger is operational
	Reset Periodic inspection by pressing the up- and down buttons on the hand control for 12 seconds (after reset service light is off)

Accessories:
.....
.....
.....

Performed by

Full name:

Date/Place:

Signature:

Approved without faults

Next inspection (YYYY/MM):/

Hoist is marked with "Out of order" and sent for repair

Hoist is not eligible for repair and taken out of service

If periodic inspection reveals any defect, wear or other damage that jeopardises the safety of the patient the hoist may not be used until the deficiency has been eliminated

The owner is notified

Notes and observations



Due to legal requirements this document or a copy must be filed with the owner's service log book

If approved without faults, apply Periodic inspection label and mark with month and year for **next** Periodic inspection. When ordering label, use item no. 1100306

Next periodic inspection

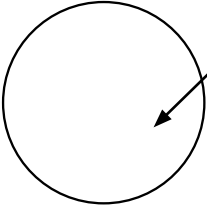

Inspection performed by:

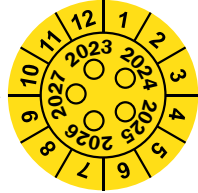

Mark label with month and year for next Periodic inspection

UK REP

Etac Ltd.

Unit 60, Hartlebury Trading Estate,
Hartlebury, Kidderminster,
Worcestershire, DY10 4JB
+44 121 561 2222

CH REP



Sodimed SA

Ch. Praz-Devant 12
CH-1032 Romanel-sur-Lausanne
+41 58 911 06 06



Etac A/S

Parallevej 3
DK-8751 Gedved



+45 796 858 33



patienthandling@etac.com



www.etac.com

molift[®]
by Etac